



Model 3001KL-AM/3001KL-AMX Antimicrobial Digital Platform Scale



User Instructions



P/N UM3001KL-AM/3001KL-AMX Rev20170921_EngOnly

Thank you for your purchase of this Health o meter® Professional product. Please read this manual carefully, and keep it for easy reference or training.

TABLE OF CONTENTS

Cautions and Warnings.....	3
Specifications	4
Certifications / Connectivity / Disposal	5
Assembly Instructions	6
Set-up Instructions	10
Operating Instructions	11
Maintenance.....	15
Calibration.....	16
Troubleshooting	17
Warranty.....	18

Note: This scale has been factory calibrated, and does not require calibration prior to use.

Please register your scale for warranty coverage at:

www.homscales.com

For User Instructions updates and revisions please go to:

www.homscales.com

CAUTIONS AND WARNINGS

To prevent patient/caregiver injury or damage to your scale, please follow the instructions in this user manual very carefully.

- Do not exceed the weight capacity specified for this scale.
- For accurate weighing, this scale must be placed on a flat, stable surface.
- For accurate weighing, verify before each use the proper operation according to the procedure described in this manual.
- Do not use in the presence of flammable or explosive materials.
- If the scale becomes damaged, it should not be operated until properly serviced.
- Do not transport the scale with a patient or object on the scale.
- To prevent injury and damage to your scale, do not drop or mishandle scale, while using or transporting scale.
- Ensure that the AC adapter and scale do not come in contact with liquids, excessive temperature, or excessive humidity.

Patient/caregiver safety

- This scale is designed for static weighing of patients only. No scale should be used for patient transfer.
- To prevent patient injury, the patient must be attended throughout the entire weighing event. Exercise caution when rolling patient onto and off of the scale.

When operating the scale with the AC adapter:

- Operate this scale exclusively with the AC adapter that is provided (ADPT30). Use of an unspecified adapter will void the warranty, and can pose a serious safety hazard.
- Prior to using this scale, inspect the AC adapter cord for cracking / fraying, or for broken / bent plug prongs.
- Prior to using this scale, ensure that the AC adapter is plugged into an outlet with the rated voltage appropriate for operation.
- Ensure that the AC adapter outlet is wired to a circuit breaker or other protected power source.
- Unplug the AC adapter, and carefully store both the adapter and adapter cord before moving the scale.
- Operating this scale at voltages and frequencies other than specified can damage the equipment and will void the warranty.

When operating the scale with batteries:

- For accurate weighing, if the "LO BAT" indicator activates, replace the batteries or switch to the AC adapter as soon as possible.
- When replacing / inserting batteries, be sure to use all new batteries.

This equipment has been tested and found to comply with the EMC limits for the Medical Device Directive 93/42/EEC (EN 55011 Class A and EN 60601-1-2). These limits are designed to provide reasonable protection against harmful interference in a typical medical installation. The equipment generates, uses and may radiate radio frequency energy and, if not installed and used in accordance with these instructions, may cause harmful interference to other devices in the vicinity. There is no guarantee that interference will not occur in a particular installation. If this equipment does cause harmful interference with other devices, which can be determined by turning the equipment off and on, the user is encouraged to try to eliminate the interference by one or more of the following measures:

- Reorient or relocate the receiving device.
- Increase the separation between the equipment.
- Connect the equipment into an outlet on a circuit different from that to which the other device(s) is connected.
- Consult Customer Service or a field service technician for help.

In no event shall Pelstar, LLC be liable for damages or injuries whatsoever arising out of or connected with the assembly, use, or misuse of its products.

SPECIFICATIONS

General

Model 3001KL-AM/3001KL-AMX digital scales use highly sophisticated microprocessor technology. Each precision scale is designed to provide accurate, reliable and repeatable weight measurements. This scale uses motion-sensing weighing technology in order to determine the actual weight of a moving patient.

Although the patient's weight can be displayed in either pounds (LB) or kilograms (KG), the scale can be "locked" such that the user cannot change the displayed Unit of Measurement (UOM).

Note: The scale is shipped from the factory locked in "KG" mode. Refer to Page 12 to learn more about configuring the scale.

Antimicrobial Powder Coating



Unique to the 3001KL-AM/3001KL-AMX scales, the handrails and transport handle have been fabricated with a permanent, antimicrobial powder coating. The antimicrobial coating utilizes silver ionic technology to inhibit the growth of microbes.

Scale Specifications

Capacity and Resolution	1000 lb x 0.2 lb (454 kg x 0.1 kg)
Power Requirements	110-240VAC, 50-60Hz to 9V DC Adapter, ADPT30, (not included) or 6 AA batteries (included)
Environmental	Operating temperatures: 50°F to 95°F (10°C to 35°C) Storage temperatures: 30°F to 125°F (0°C to 50°C) Maximum Humidity: 85% RH
Platform Dimensions	Length: 15 3/4" (46 cm) Width: 22" (56 cm) Height: 2 5/8" (6 cm)

CERTIFICATIONS / CONNECTIVITY / DISPOSAL

Certification Descriptions

	Pelstar, LLC has been officially certified as the manufacturer of Health o meter [®] Professional medical devices. The Pelstar, LLC quality assurance system covers the development, production, sales and service of medical scales and measuring systems.
	This product is tested to and meets the requirements of: 1. UL60601-1 First Edition: Safety for Medical Electrical Equipment 2. CSA C22.2 No. 601-1 M90: Medical Electrical Equipment

Connectivity Information

To enable reliable transmission of weight, height, and Body Mass Index (BMI) data, this scale is designed to connect to a computer, monitor, or other electronic device via a built-in USB port. This connectivity helps minimize transcription errors when recording patient data.

This scale is EMR-EHR compatible. For more information regarding how to connect this scale to other electronic devices, please contact Health o meter[®] Professional Scales Technical Support, available during normal business hours at 1-800-638-3722.

Scale Disposal



This Health o meter[®] Professional scale must be disposed of properly as electronic waste. Follow the national, regional or local regulations which apply to you for disposal of electronic waste or batteries. Do not dispose of this device in the domestic waste stream.

ASSEMBLY INSTRUCTIONS

***If you have received your scale already assembled, skip to Set Up Instructions on page 10.**

Before Assembly

Carefully inspect the carton for shipping damage before unpacking. If damage is found, contact your shipper or a Health o meter® Professional representative immediately at 1-800-815-6615. Claims must be filed with the shipper as soon as possible after receipt of the package. The following information details what you will find inside the main carton as you unpack the parts for assembly.

To prevent scratching any components, carefully remove each assembly from the carton and unwrap the packing materials. Set the carton aside for storage. To avoid damaging the scale parts when unpacking, do not use a box cutter, knife, scissors, or any sharp object to open the protective inner packaging.

Parts List

- (1) Scale platform
- (1) Handrail (with load cell connector cable inside)
- (1) Display Head
- (1) AC Adapter Holder
- (4) Feet
- (8) M8x20 bolts
- (4) Machine screws
- (2) Sheet metal screws

Tools Required

13 mm box wrench, Phillips head screwdriver

Note: Assembly photos in this User Instruction manual depict the gray handrails on scale model 3001KL-AM. Assembly instructions are the same for scale model 3001KL-AMX. Handrails for the 3001KL-AMX are the white handrails depicted below.



ASSEMBLY INSTRUCTIONS

Health o meter® Professional Scales recommends that assembly is performed by two people.

Warning: Do not drop scale, as this can permanently damage the load cells.

1. Remove the scale platform from the carton and place scale platform on a flat, level, and dry surface with the bottom facing up. Thread the (4) feet into the underside of the platform. Each foot should be completely hand tightened.



2. Turn the platform over so it is facing up. Locate the handrail and untie the load cell cable connector. Position the handrail over the handrail supports on the platform and feed the cable through the ring shaped hole located on the right handrail support.



3. Holding the handrail in place, tip the platform forward to be able to access the underside of the platform. Pull the cable through the ring shaped hole behind the wheel then feed the cable through the metal shield as shown.

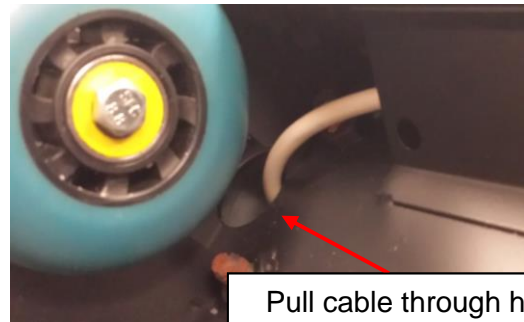

Pull cable through hole

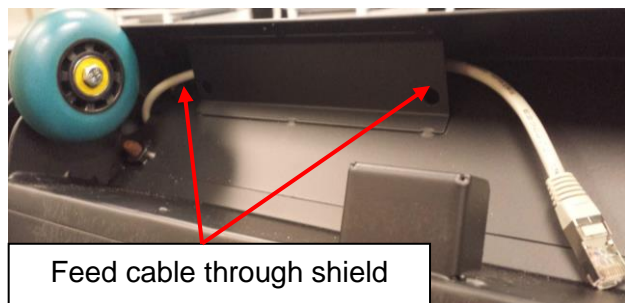

Feed cable through shield

ASSEMBLY INSTRUCTIONS

4. Tip the platform and handrails back to an upright position. Fasten the handrail to the platform using the (8) included M8x20 bolts (4 bolts per each handrail support). Use the included 13mm box wrench to tighten the bolts.



5. Carefully tilt the scale forward to access the underside of the platform. Plug the load cell connector cable into the port.

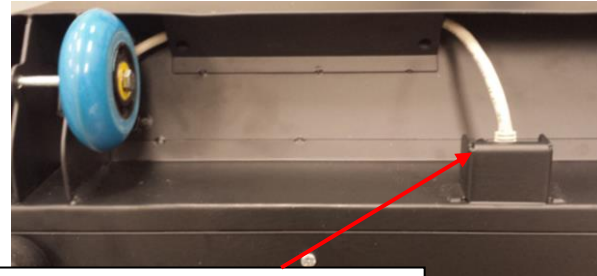

Load cell connector cable port

6. Carefully tilt the scale back to an upright position. Obtain the display head and align the four holes on the back of the display head with the four mounting holes on the display support. Fasten the display head onto the metal display support by using the (4) included pan head M3 screws. Use a Phillips head screwdriver to tighten the screws.



ASSEMBLY INSTRUCTIONS

7. Plug the load cell connector cable into the load cell port on the rear of the display head.



8. Attach the adapter holder to the handrail using the (2) included sheet metal screws. Use a Phillips head screwdriver to tighten the screws. The scale is now assembled. See Powering the Scale on page 10 for battery/AC adapter instructions.



SET-UP INSTRUCTIONS

For Pre-Assembled Scales

1. Remove the fully assembled scale by carefully lifting it out from the carton and place scale platform on a flat, level, and dry surface.
2. Remove the protective plastic film covering the display head (the film is printed "FACTORY CALIBRATED").
3. Carefully remove the batteries that are wrapped in bubble wrap and attached to the handrail. See **Powering the Scale** or **Battery Installation**, below, for battery and AC adapter instructions.

Powering the Scale

1. Plug the AC adapter into the power adapter jack (the jack is located on the rear of the display head), then plug the scale's AC adapter into the power source.

Warning: To avoid a safety hazard, do not use an unspecified AC adapter. Only use the Health o meter® Professional AC adapter model ADPT30 designed for this scale.

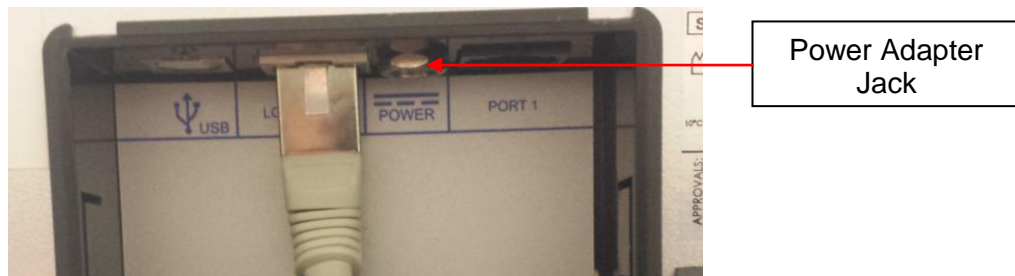

2. For battery operation, see Battery Installation below.

Battery Installation

1. If connected, unplug the AC adapter from the power source.
2. Use a Phillips head screwdriver to remove the battery cover on the side of the display head by unscrewing the (2) battery cover screws.
3. Replace or install fresh batteries, making sure to install them in the proper direction. Health o meter Professional recommends using an alkaline or lithium battery, rated for 130°F (54°C) operation. Do not use Zinc-Carbon batteries.
4. Re-attach the battery cover to the display head.

Warning: If the scale will not be used for some time, remove the batteries to avoid a safety hazard. Disposal of batteries must be performed in accordance with the prevailing national, regional or local regulations that apply to you.

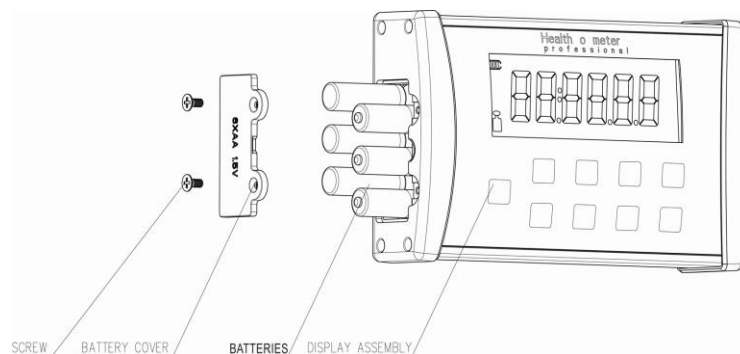

OPERATING INSTRUCTIONS

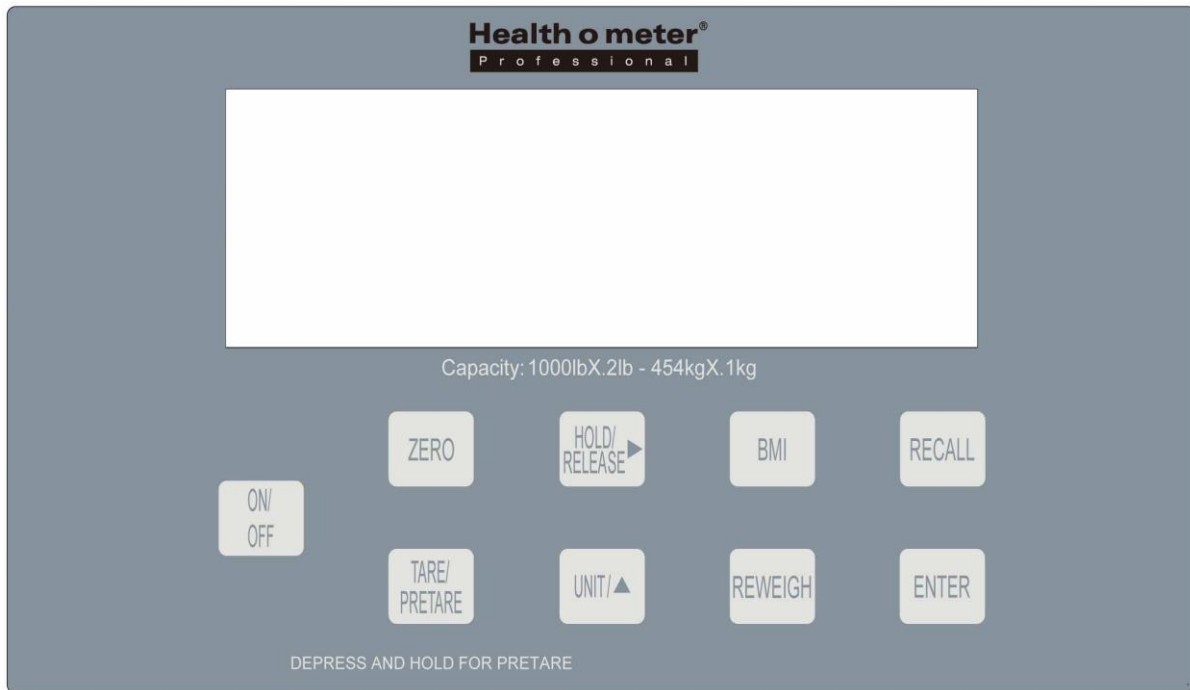

Keypad

Function	Description
ON/OFF	Powers scale on and off.
ZERO	Zeros the scale prior to a weighing.
HOLD/RELEASE ▶	Holds the weight value of the patient on the display until the button is pressed again to clear the value. Also moves the cursor from left to right on the display for entering height and pretare value.
BMI	Prompts entry of height data to calculate patient's Body Mass Index (BMI).
RECALL	Recalls the previous weight.
TARE/PRETARE	TARE-Deducts the weight of an object on the platform. PRETARE-Prompts entry of a weight value that will be deducted from the weight on the platform. Also releases tare weight (returns display to zero).
UNIT/▲	Toggles between pounds and kilograms. Also used to increment height value and pretare value.
REWEIGH	Allows repeated weighing of the patient without stepping off the scale.
ENTER	Used to accept height value in BMI mode, and tare value in PRETARE mode. Also releases the RECALL value and BMI value.

OPERATING INSTRUCTIONS (CONT)

Unit of Measure Configuration

The scale ships from the factory locked in “KG” mode. In this configuration, the scale will power up and exclusively display the patient’s weight in kilograms. Depressing the **UNIT** button will not change the Unit of Measure (UOM).

1. To unlock the UOM, turn the scale on and wait until “0.0 KG” is displayed. Press and hold the **UNIT** button for approximately 30 seconds. When the display beeps and “KG” begins to flash on the display, release the **UNIT** button.
2. The **UNIT** button is now active. Pressing the **UNIT** button will change the UOM from KG to LB and back to KG.
3. To re-configure the scale and lock back into “KG” mode, press the **UNIT** button and set the unit of measure to “0.0 KG”. Press and hold the **UNIT** button for approximately 30 seconds. When the display beeps and “KG” begins to flash on the display, release the **UNIT** button. The **UNIT** button is now disabled, and the scale is now locked in “KG” mode.
4. The scale can also be locked into “LB” mode by following the instructions in step 3. Before holding down the **UNIT** button, the UOM must be set to “LB” mode.

Weighing a Patient

1. Make sure there is nothing on the weighing platform.
2. Press the **ON/OFF** button to turn on the scale.
3. Wait until the “0.0” LB or “0.0” KG appears on the display.
4. Ask the patient to step on the scale. The scale will begin to display the patient’s weight and will lock on the patient’s weight when completed. Depending on the movement of the patient on the scale, it may take several seconds for the scale to lock onto the weight.
5. The weight may be held on the display by pressing the **HOLD/RELEASE** button. The scale will continue to display the patient’s weight after they step off the scale and will remain on the display until released or the scale is powered off. To release, press the **HOLD/RELEASE** button again.
Note: If Auto Off is enabled, the scale will not power off if a weight is being held on the display.
6. After recording the weight, have the patient step off the scale.
7. Press the **ON/OFF** button to power the scale off.

BMI Function

Note: The scale will not calculate BMI for a patient weighing less than 24 pounds (12 kg). If a height is not entered for the patient within 30 seconds of pressing the **BMI** button, the scale will return to normal weighing mode.

1. Make sure there is nothing on the weighing platform.
2. Press the **ON/OFF** button to turn on the scale.
3. Wait until the “0.0” LB or “0.0” KG appears on the display.
4. Ask the patient to step on the scale. The scale will begin to display the patient’s weight and will lock on the patient’s weight when completed. Depending on the

OPERATING INSTRUCTIONS (CONT)

movement of the patient on the scale, it may take several seconds for the scale to lock onto the weight.

5. After obtaining the patient's weight, and with the patient remaining on the scale, press the **BMI** button.
6. The scale will prompt entry of the patient's height. Use the keypad **▲** and **▶** buttons to enter the patient's height.
Note: When weighing in pounds, the height is displayed in inches. When weighing in kilograms, the height is displayed in centimeters.
7. Once height is keyed in, press the **ENTER** button.
8. The display will show the patient's **BMI**.
9. Press the **ENTER** button to return to the normal weighing mode.

Weight Recall

The last weight reading on the scale can be recalled by pressing the **RECALL** button. The last weight reading can be recalled after the scale has automatically or manually powered off. To clear the display of the recalled weight, press the **ENTER** button.

Tare Function

When using this scale, the weight of an object, such as a cane, can be subtracted from the total weight in order to determine the weight of the patient alone. The Tare Function automatically performs this subtraction. The scale allows a tared weight to be entered manually by using the keypad, or automatically, as outlined in this section.

Tare

1. With all weight off the scale, press the **ON/OFF** button to turn on the scale.
2. Wait until the "0.0" LB or "0.0" KG appears on the display.
3. Place the object to be tared on the scale. The display will show the object's weight.
4. Press the **TARE** button. The scale will zero out, and the word "TARE" will appear at the bottom center of the display, indicating that there is a tare value for the object.
5. Remove the object from the scale. Once the object is removed from the scale, the display will show a negative weight, equal to the weight of the object.
6. Place the patient and the object back on the scale. The scale will automatically deduct the tare weight of the object from the gross weight of the patient and object together.
7. The display will show the patient's weight.
8. With no weight on the scale, the tare value will remain on the display until changed, cleared, or until the scale is powered off.
9. To remove the Tare, press the **TARE** button. The word "TARE" will disappear from the bottom of the display, and the tare value will be cleared from the display. The scale will resume normal operation.

To Tare with a Known Weight / Pre-Tare (Limit 200 lb / 91kg)

1. Make sure that there is nothing on the scale.
2. Press the **ON/OFF** button to turn on the scale.
3. Wait until the "0.0" LB or "0.0" KG appears on the display.

OPERATING INSTRUCTIONS (CONT)

4. Press the **TARE** button for 3 to 5 seconds. The word “TARE” will appear at the bottom center of the display, prompting the user to enter the tare value.
5. Use the keypad ► and ▲ buttons to enter the weight of the object. Press the **ENTER** button when finished.
6. The value entered will show as a negative value on the display.
7. Place the patient and the object on the scale. The scale will automatically deduct the tare weight entered from the gross weight of the patient and the object.
8. The display will show the patient’s weight.
9. With no weight on the scale, the tare value will remain on the display until changed, cleared, or until the scale is powered off.
10. To remove the Tare, press the **TARE** button again. The word “TARE” will disappear from the display and the tare value will be cleared from the display. The scale will resume normal operation.

Parent/Child Function

The Parent/Child function on Health o meter® Professional scales provides the convenience of weighing a small child or infant while being held by a parent. Follow these simple steps to subtract the parent’s weight from the total so only the child’s weight is displayed.

1. With all weight off the scale, press the **ON/OFF** button to turn the scale on.
2. Wait until “0.0” LB or “0.0” KG appears on the display.
3. Ask the parent to step onto the scale without the child. The display will show a value for the parent’s weight.
4. Press the **TARE** button. The scale will zero out, and the word “TARE” will appear at the bottom center of the display, indicating that there is a tare value for the parent’s weight.
5. Ask the parent to step off of the scale. Once the parent is off of the scale, the display will show a negative weight, equal to the parent’s weight.
6. Ask the parent to step back onto the scale while holding the child. The scale will automatically deduct the weight of the parent and only display the child’s weight.
7. With no weight on the scale, the tare value will remain on the display until changed, cleared, or until the scale is powered off.
8. To remove the Tare, press the **TARE** button. The word “TARE” will disappear from the bottom of the display, and the tare value will be cleared from the display. The scale will return to normal weighing mode.

Deactivating the Auto-Off Feature

The scale is shipped with the Auto Off feature enabled. To deactivate the Auto Off feature, while the scale is off, press and hold down the **TARE** button. While holding down the **TARE** button power on the scale by pressing the **ON/OFF** button. “START” will briefly appear on the display followed by “AOF=0”. The Auto-Off feature has now been deactivated and the scale will remain on until manually powered off.

Activating Auto Off Feature

While the scale is off, press and hold down the **TARE** button. While holding down the **TARE** button power on the scale by pressing the **ON/OFF** button. “START” will briefly appear on the display followed by “AOF=1”. The Auto-Off feature has now been enabled and the scale will shut off after 2-3 minutes of inactivity.

MAINTENANCE

Maintenance

The following pages provide instructions for maintenance, cleaning, calibration, and troubleshooting for the 3001KL-AM/3001KL-AMX scales. Maintenance operations other than those described in this manual should be performed by qualified service personnel.

Caution: Before first use, or after long periods of non-use, check the scale for proper operation and function. If the scale does not operate correctly, refer to qualified service personnel.

1. Check the overall appearance of the scale for obvious damage, wear, and tear.
2. If applicable, inspect the AC adapter for cord cracking, fraying, and for broken/bent prongs.

Cleaning

Proper care and cleaning is essential to ensure a long life of accurate and effective weighing.

Caution: Disconnect the scale from the AC adapter power source prior to cleaning the unit.

Note: Routine cleaning does not affect the antimicrobial properties of the handrail coating.

1. Clean all external surfaces with a clean damp cloth or tissue. Dry with a clean soft cloth.
2. Do not immerse the scale into cleaning or other liquid solutions.
3. Do not use Isopropyl Alcohol or other solutions to clean the display surface.
4. Do not use abrasive cleaners.

Replacement Parts

Part #	Description
B2266701-0	PLASTIC FOOT ASSEMBLY
DISPLAY1100	DISPLAY HEAD
LKIT1100	ELECTRONICS KIT

CALIBRATION

This scale has been factory calibrated, and does not require calibration prior to use.

Calibration of your 3001KL-AM/3001KL-AMX scale can be performed using calibrated kilogram (kg) or pound (lb) weight standards. The required calibration standard will be the Unit of Measure (UOM) for which the scale is configured.

Because the scale is shipped from the factory in “KG” mode, the requested UOM for calibration will be the KG standard (e.g., 400kg). If the unit is to be calibrated with LB weight standards, the scale must first be configured to the “LB” UOM. Refer to the **Unit of Measure Configuration** section on page 12 for configuration details.

Note: Only weights certified and traceable to national standards are to be used for calibration.

Warning: Always ensure that the scale is returned to the correct UOM after scale calibration.

Operator Action	Display
1. Ensure the display is powered off, then press and hold the HOLD/RELEASE and ZERO button while pressing the ON/OFF button. (Two alphanumeric characters will appear next to “U” followed by 4-5 characters.)	U”XX” followed by a 4-5 digit ‘idle scale count’ number.
2. Press the ENTER button.	“CAL”.
3. Make sure there is nothing on the scale, then press the ENTER button.	“Clear” followed by "400.0 KG" (in KG mode) or “0400.0 LB” (in LB mode)
4. Use the ► and ▲ buttons to set the calibration weight to a value other than the default weight. The calibration weight should be as high as possible, with 270 KG/400 LB as a minimum calibration weight.	Shows "400.0 KG" (in KG mode) or “0400.0 LB” (in LB mode) or entered calibration weight.
5. Press the ENTER button.	Displays “Load” followed by "400.0 KG" (in KG mode) or “0400.0 LB” (in LB mode)
6. Load the scale with the required weight.	Display increments showing raw weight data.
7. Without touching or shaking the scale, allow the display to stabilize, then press the ENTER button.	“SUCC” or “Err1”.
8. If the calibration is successful, the display will show SUCC and power off. If the calibration is not successful, the display will show Err1 and power off. Contact customer service for an “Err1” display (+1 800-638-3722).	-----

TROUBLESHOOTING

Troubleshooting

Before contacting service personnel, refer to the following instructions to check and to correct any failures.

Symptom	Possible Cause	Corrective Action
Scale does not power on	<ol style="list-style-type: none"> 1. Dead Battery 2. Faulty electrical outlet 3. Bad power supply 	<ol style="list-style-type: none"> 1. Replace batteries 2. Use a different outlet 3. Replace AC adapter
Questionable weight or the scale does not zero	<ol style="list-style-type: none"> 1. External object interfering with the scale 2. The display did not show "0.0" before weighing 3. Scale is not placed on a level floor or feet are not properly balanced. 4. Scale is out of calibration 5. Improper Tare 	<ol style="list-style-type: none"> 1. Remove interfering object from the scale 2. Ask the patient to get off the scale, zero the scale and begin weighing process again 3. Place the scale on a level floor. Tighten the feet on the underside of the platform to ensure all 4 feet are properly balanced 4. Check weight with known weight value 5. Place the item to be tared on the scale. Press REWEIGH. Once the weight of the item is displayed, press TARE. Place the patient and the tared item back on the scale. Press REWEIGH again
Weighing is performed but the weighing process takes too long and the weight does not lock on the display	The patient is not sitting or standing still	Ask the patient to stand or sit still
The display shows "Over" message	The load on the scale exceeds the capacity (1000 lb / 454 kg)	Remove the excess weight and use the scale according to its limits
The display shows "Lo bAtt" message	The batteries are depleted	Replace batteries according to instructions on page 10

WARRANTY

Limited Warranty

What does the Warranty Cover?

This Health o meter® Professional scale is warranted from date of purchase against defects of materials or in workmanship for a period of two (2) years. If product fails to function properly, return the product, freight prepaid and properly packed to Pelstar, LLC (see "To Get Warranty Service", below, for instructions). If the manufacturer determines that a defect of material or in workmanship exists, the customer's sole remedy will be replacement of the scale at no charge. Replacement will be made with a new or remanufactured product or component. If the product is no longer available, replacement may be made with a similar product of equal or greater value. All replaced parts are covered only for the original warranty period.

Who is Covered?

The original purchaser of the product must have proof of purchase to receive warranty service. Please save your invoice or receipt. Pelstar dealers or retail stores selling Pelstar products do not have the right to alter, or modify or any way change the terms and conditions of this warranty.

What is Excluded?

Your warranty does not cover normal wear of parts or damage resulting from any of the following: negligent use or misuse of the product, use on improper voltage or current, use contrary to the operating instructions, abuse including tampering, damage in transit, or unauthorized repair or alternations. Further, the warranty does not cover natural disasters, such as fire, flood, hurricanes and tornadoes. This warranty gives you specific legal rights, and you may also have other rights that vary from country to country, state to state, province to province or jurisdiction to jurisdiction.

To get Warranty Service make sure you keep your sales receipt or document showing proof of purchase. Call (+1) 800-638-3722 or (+1) 708-377-0600 to receive a return authorization (RA) number, which must be included on the return label. Attach your proof of purchase to your defective product along with your name, address, daytime telephone number and description of the problem. Carefully package the product and send with shipping and insurance prepaid to:

Pelstar, LLC
Attention R/A# _____
Return Department
9500 West 55th Street
McCook, IL 60525



PELSTAR, LLC

9500 West 55th Street • McCook, IL 60525 • USA

1-800-638-3722 or 1-708-377-0600

PLEASE REGISTER YOUR SCALE FOR WARRANTY COVERAGE AT: <http://www.homscal.es.com>

Health o meter® is a registered trademark of Sunbeam Products, Inc. used under license.

Health o meter® Professional products are manufactured, designed, and owned by Pelstar, LLC.

We reserve the right to improve, enhance, or modify Health o meter® Professional product features or specifications without notice.

© Pelstar, LLC 2017



P/N UM3001KL-AM/3001KL-AMX Rev20170921_EngOnly